

BHARAT PRIMARY BELT SCRAPER SHD

BMD BHARAT PRIMARY BELT SCRAPER SHD

is design for rugged condition, its removing carry back effectively & efficiently, it is a highly effective solution to enhance material flow performance.

BMD ENGINEERING SOLUTIONS newly enhanced primary belt scraper **SHD** which is having single polyurethane blade & heavy telescopic mainframe in structural steel. It allows quick and easy service with "one-pin" replacement of a "one-piece" blade.

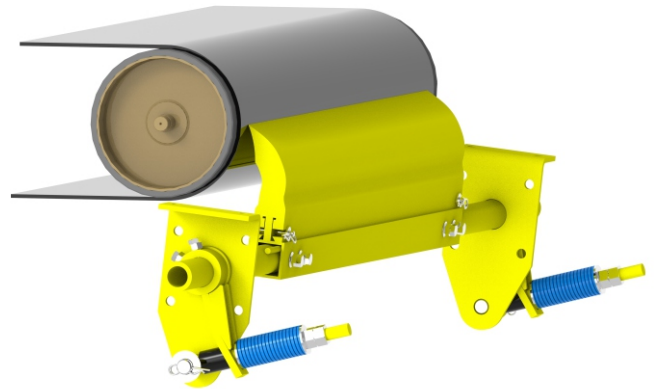

SPECIFICATIONS

Belt Width	Belt Speed	Pulley Diameter** (mm)	Maximum Service Temperature	Comptible with Reversing belt	Wear Life*
Up to 2400 mm	Up to 6.5 m/s	Up to 850 mm	150°C Continuous 177°C Intermittent	Yes	205 mm

** Pulley diameter 850 mm and greater:
contact your BMD Engineering Solutions representative.

NOMENCLATURE

BH-XXX-XXX-BW-BC-XXX-XXX

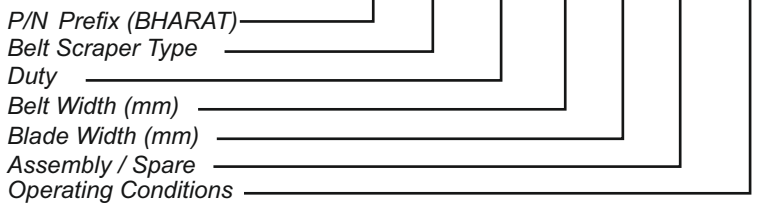

MOUNTING LOCATION

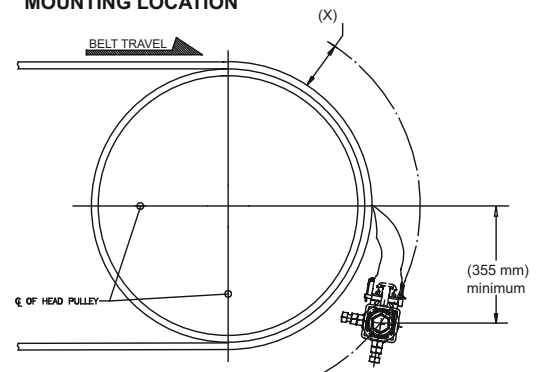

BELT SCRAPER TYPE

PBS: PRIMARY BELT SCRAPER

DUTY

SHD: SUPER HEAVY DUTY

MAINFRAME & BLADE

ASM: ASSEMBLY

SPR: BLADE & LOCK PINS

OPERATING CONDITION

AMB: AMBIENT

HRT: HEAT RESISTANT

BELT WIDTH (mm)	BLADE COVERAGE (mm)
600	500
800	750
1000	850
1200	1050
1400	1250
1600	1450
1800	1650
2000	1850
2200	2050
2400	2250

Pulley Diameter* (mm)	Dimension X (mm)
400	146
500	140
600	133
700	127
750	120

*Includes lagging & belt

DIMENSIONS --(mm)

* Tensioner not included



Belt Width mm	Mainframe Length (B) mm (Min-Max)	Blade Coverage (A) (mm)	Shipping Weight* (kg)	PU Blade Colour	
				For Ambient Temp.	For 80-150°C.
500-650	500-800	450	51	Sulfer Yellow	Green
650-800	650-1000	500	63	Sulfer Yellow	Green
800-1000	800-1500	750	75	Sulfer Yellow	Green
1000-1200	1000-1900	950	87	Sulfer Yellow	Green
1200-1400	1200-2300	1050	99	Sulfer Yellow	Green
1400-1600	1400-2500	1250	111	Sulfer Yellow	Green
1600-1800	1600-2700	1350	122	Sulfer Yellow	Green
1800-2000	1800-2900	1650	135	Sulfer Yellow	Green
2000-2200	2000-3100	1850	145	Sulfer Yellow	Green
2200-2400	2200-3600	2050	156	Sulfer Yellow	Green

Note: Dual side tensioner's are required for all belt widths.

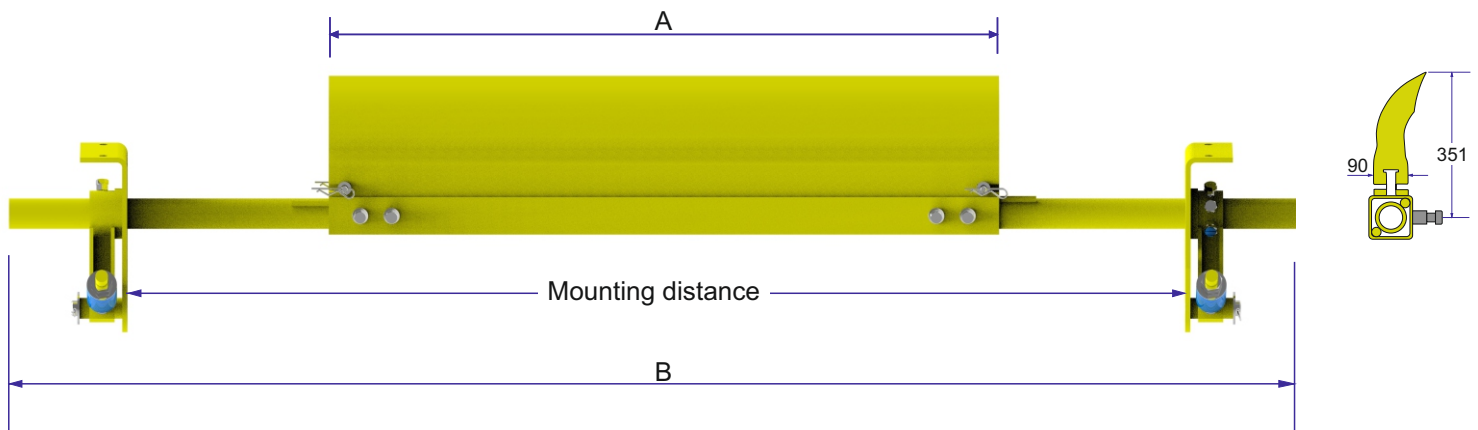
Mainframes are all telescopic type for easy Installation



BMD HIGH-PERFORMANCE URETHANES

Urethane Color	Application Description	Typical Material	Temperature Range
	Sulfer Yellow Standard BMD Urethane is suitable for most belt cleaner applications, including abrasive conditions and exposure to solvents or oil. chemicals and reduced absorption of water in high-moisture environments.	Bauxite, coke, coal, refuse, steel/ore, limestone etc.	-30°C to 70°C
	Green High-Temperature Urethane withstands exposure to intermittent temperatures of up to (150°C).	Clinker	-40°C to 150°C

BMD ENGINEERING SOLUTIONS

Works At:- Plot No. C 39/2, Mhalunge, Chakan MIDC, Phase-1, Pune (MH) - 410501, Mob.- 77353 89730 / 83800 90023.

E-mail:- sales@bmdindia.com , bmdengineeringsales@gmail.com , Web: www.bmdindia.com